

DECEMBER 1993

V.I.P. PLAT NO. 2

SHEET 1 of 2

144

BEING A REPLAT OF A PORTION OF MILITARY TRAIL PROPERTY, PORT OF PALM BEACH DISTRICT, ACCORDING TO THE PLAT THEREOF, AS RECORDED IN PLAT BOOK 42, PAGE 124, PUBLIC RECORDS, PALM BEACH COUNTY, FLORIDA, AND LYING IN SECTION 36, TOWNSHIP 42 SOUTH, RANGE 42 EAST, CITY OF RIVIERA BEACH, PALM BEACH COUNTY, FLORIDA.

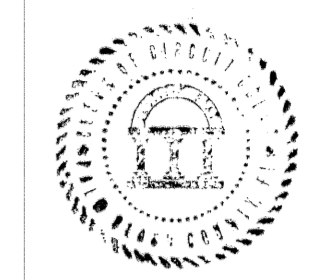

STATE OF FLORIDA)
) SS
 COUNTY OF PALM BEACH)

THIS PLAT WAS FILED FOR RECORD AT 10:22 AM, THIS 25 DAY OF May, A.D., 1993, AND DULY RECORDED IN PLAT BOOK 72, ON PAGES 144 THROUGH 145

DOROTHY H. WILKEN
 CLERK OF THE CIRCUIT COURT
 BY *Leif A. Stalle*
 DEPUTY CLERK

DEDICATION:

STATE OF FLORIDA)
) SS
 COUNTY OF PALM BEACH)

KNOW ALL MEN BY THESE PRESENTS, THAT FIBREGLASS WATER FLUMES, INC., A FLORIDA CORPORATION, OWNER OF THE LAND SHOWN HEREON, AS "V.I.P. PLAT NO. 2" SAID LAND BEING A REPLAT OF A PORTION OF MILITARY TRAIL PROPERTY, PORT OF PALM BEACH DISTRICT, ACCORDING TO THE PLAT THEREOF, AS RECORDED IN PLAT BOOK 42, PAGE 124, PUBLIC RECORDS, PALM BEACH COUNTY, FLORIDA LYING IN SECTION 36, TOWNSHIP 42 SOUTH, RANGE 42 EAST, CITY OF RIVIERA BEACH, PALM BEACH COUNTY, FLORIDA; SAID LAND BEING MORE PARTICULARLY DESCRIBED AS FOLLOWS:

PLAT OF MILITARY TRAIL PROPERTY, PORT OF PALM BEACH DISTRICT, CITY OF RIVIERA BEACH, FLORIDA, IN SECTION 36, TOWNSHIP 42 SOUTH, RANGE 42 EAST, PALM BEACH COUNTY, FLORIDA, AS RECORDED IN PLAT BOOK 42, PAGE 124 OF THE PUBLIC RECORDS OF SAID COUNTY; LESS THE FOLLOWING DESCRIBED PARCEL:

BEGINNING AT THE NORTHEAST CORNER OF SAID MILITARY TRAIL PROPERTY, PORT OF PALM BEACH PLAT; THENCE SOUTH 02 DEGREES 01 MINUTES 04 SECONDS WEST ALONG THE EAST LINE OF SAID PLAT, A DISTANCE OF 219.52 FEET, SAID EAST LINE BEING COINCIDENT WITH THE EAST LINE OF SECTION 36, TOWNSHIP 42 SOUTH, RANGE 42 EAST; THENCE NORTH 88 DEGREES 10 MINUTES 01 SECONDS WEST, A DISTANCE OF 115.00 FEET; THENCE, SOUTH 02 DEGREES 01 MINUTES 04 SECONDS WEST, A DISTANCE OF 75.00 FEET TO A POINT ON THE NORTH RIGHT-OF-WAY LINE OF PORTWEST ROAD (BEING AN 80 FOOT RIGHT-OF-WAY) (THE LAST TWO COURSES BEING COINCIDENT WITH THE BOUNDARY OF SAID PORT OF PALM BEACH DISTRICT PLAT); THENCE, NORTH 88 DEGREES 10 MINUTES 01 SECONDS WEST ALONG SAID NORTH RIGHT-OF-WAY LINE OF PORTWEST ROAD, A DISTANCE OF 1886.42 FEET, SAID RIGHT-OF-WAY BEING COINCIDENT WITH THE SOUTH LINE OF SAID PORT OF PALM BEACH DISTRICT PLAT; THENCE, NORTH 01 DEGREES 40 MINUTES 59 SECONDS EAST, A DISTANCE OF 292.96 FEET TO A POINT ON THE NORTH LINE OF SAID PORT OF PALM BEACH DISTRICT PLAT; THENCE, SOUTH 88 DEGREES 12 MINUTES 41 SECONDS EAST ALONG SAID NORTH LINE, A DISTANCE OF 2002.37 FEET TO THE POINT OF BEGINNING (SAID NORTH LINE BEING COINCIDENT WITH THE NORTH LINE OF THE NORTH ONE-HALF OF THE SOUTH ONE-HALF OF THE NORTH ONE-HALF OF THE SOUTH ONE-QUARTER OF SAID SECTION 36).

CONTAINING: 4.08 ACRES, MORE OR LESS

HAS CAUSED THE SAME TO BE SURVEYED AND PLATTED, AND DOES HEREBY MAKE THE FOLLOWING DEDICATIONS AND/OR RESERVATIONS:

- TRACT "A", AS SHOWN HEREON, IS HEREBY DEDICATED TO THE CITY OF RIVIERA BEACH, FOR THE PERPETUAL USE OF THE PUBLIC FOR PUBLIC STREET PURPOSES.
- TRACT "B", AS SHOWN HEREON, IS HEREBY RESERVED BY FIBREGLASS WATER FLUMES, INC., A FLORIDA CORPORATION, FOR PROPER PURPOSES AND IS THE PERPETUAL MAINTENANCE OBLIGATION OF FIBREGLASS WATER FLUMES, INC., A FLORIDA CORPORATION, WITHOUT RECOURSE TO THE CITY OF RIVIERA BEACH.

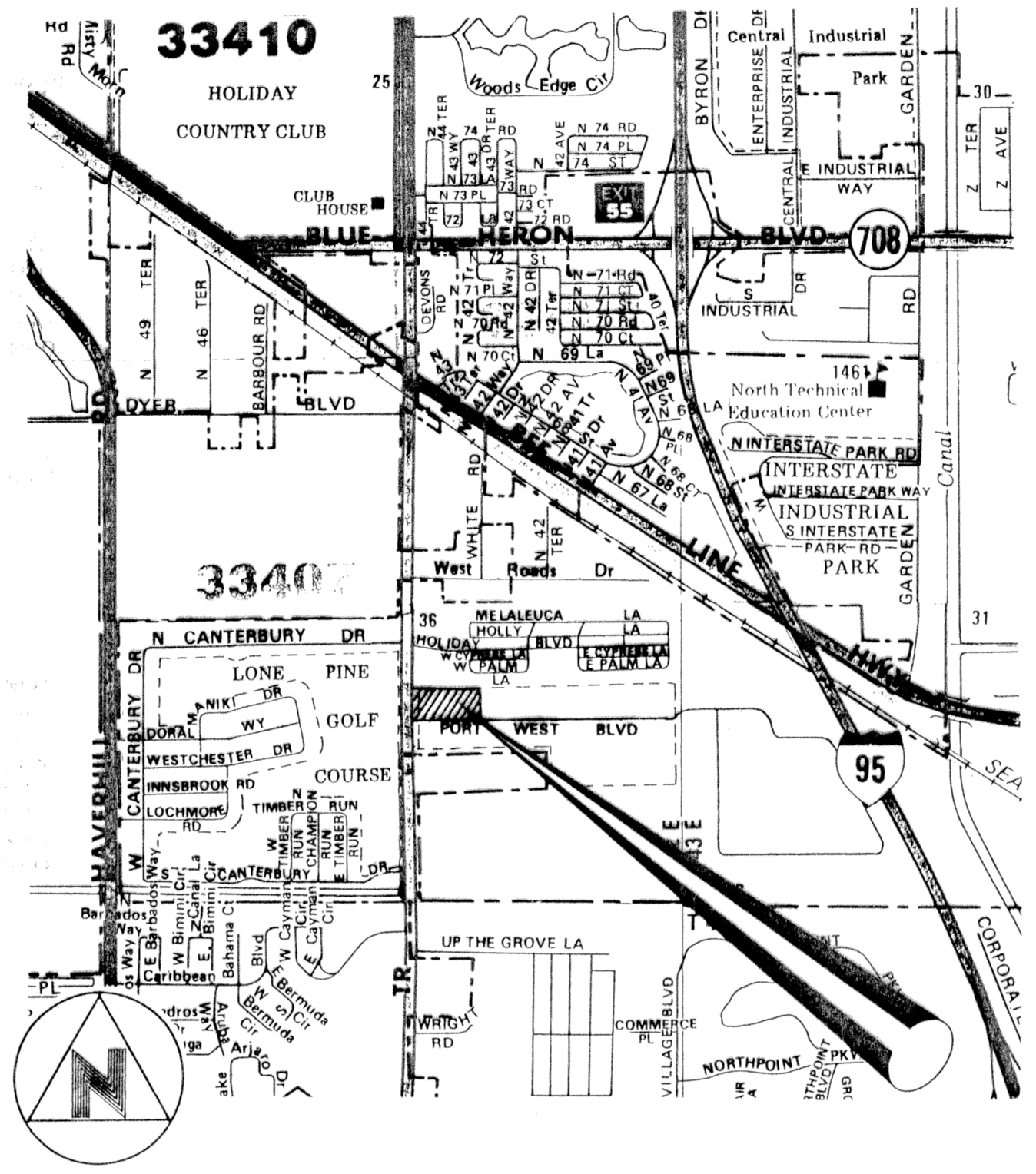

LOCATION MAP (NOT TO SCALE)

TITLE CERTIFICATION:

STATE OF FLORIDA)
) SS
 COUNTY OF PALM BEACH)

WE, ALLEY, MAASS, ROGERS & LINDSAY, A DULY LICENCED LAW FIRM IN THE STATE OF FLORIDA, HEREBY CERTIFY THAT I HAVE EXAMINED THE TITLE TO THE HEREON DESCRIBED PROPERTY; THAT I FIND THE TITLE TO THE PROPERTY IS VESTED TO FIBREGLASS WATER FLUMES, INC., A FLORIDA CORPORATION; THAT THE CURRENT TAXES HAVE BEEN PAID; THAT THERE ARE NO MORTGAGES OF RECORD.

ALLEY, MAASS, ROGERS & LINDSAY
EDWARD D. LEWIS, ESQUIRE

DATED: THIS 13TH DAY OF APRIL, A.D., 1994

BY: *Edward D. Lewis*
 EDWARD D. LEWIS, ESQUIRE - FOR THE FIRM

CITY APPROVAL:

IT IS HEREBY CERTIFIED THAT THIS PLAT OF "V.I.P. PLAT NO. 2" HAS BEEN OFFICIALLY APPROVED FOR RECORD BY THE CITY OF RIVIERA BEACH, FLORIDA, THIS 20 DAY OF May, 1994.

BY: *Clara K. Williams*
 CLARA K. WILLIAMS
 MAYOR

BY: *Carrie E. Ward*
 GWENDOLYN E. DAVIS
 CITY CLERK DEPUTY

BY: *Lal John Samadi*
 LAL JOHN SAMADI, P.E.
 CITY ENGINEER

SURVEYOR'S CERTIFICATION:

STATE OF FLORIDA)
) SS
 COUNTY OF PALM BEACH)

I HEREBY CERTIFY, THAT THE PLAT SHOWN HEREON IS A TRUE AND CORRECT REPRESENTATION OF A SURVEY MADE UNDER MY RESPONSIBLE DIRECTION AND SUPERVISION; THAT SAID SURVEY IS ACCURATE TO THE BEST OF MY KNOWLEDGE AND BELIEF; THAT (P.R.M.'S) PERMANENT REFERENCE MONUMENTS AND (P.C.P.'S) PERMANENT CONTROL POINTS HAVE BEEN PLACED AS REQUIRED BY LAW; AND FURTHER, THAT THE SURVEY DATA COMPLIES WITH ALL THE REQUIREMENTS OF CHAPTER 177, FLORIDA STATUTES, AS AMENDED, AND THE ORDINANCES OF THE CITY OF RIVIERA BEACH, FLORIDA.

BENCH MARK LAND SURVEYING & MAPPING, INC.

DATED: THIS 23 DAY OF DECEMBER, A.D., 1993.

BY: *Wm. R. Van Campen*
 WM. R. VAN CAMPEN, R.L.S.
 FLORIDA REGISTRATION NO. 2424

SURVEYOR'S NOTES:

- BEARINGS SHOWN OR STATED HEREON, ARE BASED ON OR RELATIVE TO THE BEARING OF NORTH 01 53'10" EAST ALONG THE WEST LINE OF THE SOUTHEAST ONE-QUARTER OF SECTION 36, TOWNSHIP 42 SOUTH, RANGE 42 EAST, STATE PLANE GRID AZIMUTHS, FLORIDA EAST ZONE, PALM BEACH COUNTY, FLORIDA.
- DENOTES A SET #2424 PERMANENT REFERENCE MONUMENT (P.R.M.).
- DENOTES A FOUND PERMANENT REFERENCE MONUMENT (P.R.M.).
- NOTICE: THERE MAY BE ADDITIONAL RESTRICTIONS THAT ARE NOT RECORDED ON THIS PLAT, THAT MAY BE FOUND IN THE PUBLIC RECORDS OF PALM BEACH COUNTY, FLORIDA.

IN WITNESS WHEREOF, FIBREGLASS WATER FLUMES, INC., A FLORIDA CORPORATION, HAS CAUSED THESE PRESENTS TO BE SIGNED BY ARTHUR J. POISSON AND THOMAS G. LUMBRA, JR., AS PRESIDENT AND SECRETARY, RESPECTIVELY, OF FIBREGLASS WATER FLUMES, INC., A FLORIDA CORPORATION, AND ITS CORPORATE SEAL TO BE AFFIXED HERETO, BY AND WITH THE AUTHORITY OF ITS BOARD OF DIRECTORS THIS ___ DAY OF ___, A.D., 1993.

BY: **FIBREGLASS WATER FLUMES, INC.**
 A FLORIDA CORPORATION

ATTEST: *Thomas G. Lumbra Jr.*
 THOMAS G. LUMBRA, JR., SECRETARY

BY: *Arthur J. Poisson*
 ARTHUR J. POISSON, PRESIDENT

ACKNOWLEDGMENT:

STATE OF FLORIDA)
) SS
 COUNTY OF PALM BEACH)

BEFORE ME PERSONALLY APPEARED ARTHUR J. POISSON AND THOMAS G. LUMBRA, JR., AS PRESIDENT AND SECRETARY, RESPECTIVELY, OF FIBREGLASS WATER FLUMES, INC., A FLORIDA CORPORATION, WHO ARE PERSONALLY KNOWN TO ME, AND WHO EXECUTED THE FOREGOING INSTRUMENT, AND ACKNOWLEDGED BEFORE ME THAT THEY EXECUTED SAID INSTRUMENT FOR THE PURPOSE EXPRESSED THEREIN.

WITNESS MY HAND AND OFFICIAL SEAL THIS 5TH DAY OF MAY, 1994

MY COMMISSION EXPIRES:

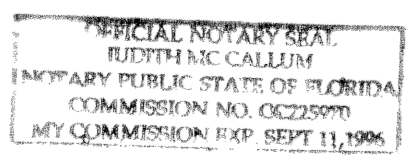

Judith McCallum
 NOTARY PUBLIC
JUDITH MCCALLUM

AREA TABULATION

TRACT "A" 0.06 ACRES
 TRACT "B" 4.02 ACRES
 TOTAL 4.08 ACRES

This instrument was prepared by Wm. R. Van Campen, R.L.S., in and for the offices of Bench Mark Land Surveying & Mapping, Inc., 4152 West Blue Heron Boulevard, Suite 121, Riviera Beach, Florida.

BENCH MARK
 Land Surveying and Mapping, Inc.
 4152 West Blue Heron Blvd., Suite 121, Riviera Beach, FL 33404
 For (407) 844-9200 Fax (407) 844-2102

RECORD PLAT
V.I.P. PLAT NO. 2

DWN	FB	DATE 5-28-93	WO # 1001
CKD	FILE	SCALE	SHEET

SUBDIVISION # V.I.P. Plat No. 2
 BOOK 72 PAGE 144
 FLOOD MAP # -
 FLOOD ZONE -
 ZONING -
 ZIP CODE -
 36/46/146
 RIVIERA Bch

TA2 115